

# Data Sheet

Item No. S5050-LED-RGB-DD

Low Cost LED RGB Strip 5050 SMD 5m 16.4ft | Double 60LED/m IP40

## LED INFO ON LED STRIP

LED Density	18 /ft - 60 /m
LED Count (Total)	300 Per Reel
LED Type	Selected 5050 SMD
LED Ambience Operating Temperature	-50° - 165° F

## POWER\*

Working Voltage / Input Voltage / Voltage Forward	12V DC
Power Consumption (Watts) <i>Max.</i>	2.5 W/ft - 8.40 W/m - 42 W/5 m Reel
Current Draw / Input Current / Current <i>Max.</i>	3500 mA - 3.5 A - 5 m Reel
Power Drop Along The Strip (Meter) <i>Approx.</i>	1 m 8% - 5 m 40%

## PHOTOMETRY

Light Color	RGB - Red, Green, Blue - 16 Million Colors Posibles
Peak Wave Length (nm)	Red 625/ Green 524/ Blue 471
Brightness (Lumen)	110 lm/ft - 360.80 lm/m - 1804 lm/Reel (5 m)
Beam Angle (Degree)	120°
UV/IR Emission	None
Lifespan / Average Lifetime / Lumen Maintenace	40,000 - 60,000 Hours (50% Brightness Loss)

## DIMENSIONS

Reel Total Length (Feet - Meter)	16.4 ft - 5 m
LED Spacing Between Centers (Inches - Milimeters)	.67 in -17 mm
LED Spacing Between Edges (Inches - Milimeters)	.45in -11.60 mm
Minimun Cuttable Segments (Inches - Milimeters)	1.96 in - 50mm (3 LED)
Width (Inches - Milimeters)	0.39 in - 10 mm
Height (Inches - Milimeters)	0.08 in - 2 mm
Cable Leads (Inches - Milimeters)	7 in - 178 mm
LED Strip Dimension Drawing	

## LED STRIP INFORMATION

LED Strip IP Rating	Non Waterproof IP40
LED Strip Adhesive	High Quality 3M Adhesive
LED Strip Finish Color / Product Color	White
LED Strip Weight (Without Packaging Material)	2.5 oz. - 70.87 g
LED Strip Warranty	30 Days Limited

## PRODUCT COUNTRY OF ORIGIN

QC Quality Control	China
Product Engineering & Design	China
Assembled	China
Technical Support	USA
Product Customization	USA Available

## INSTALLATION MATERIALS & ASSOCIATED PROD.

Dimming and Color Mixing Options	DMX, Radio Frequency (RF), Infrared (IR), & Analog
Max Length in One Run for Linear Lighting	Unlimited Thru .Amplifiers or DMX Controllers
Power Supply	Options Available
DMX Programming & Stand Alone	Options Available
LED RGB Strip Connectors	Options Available
Installation Cable 4 Wires	Options Available
Installation Cable 2 Wires	Options Available
Installation Accessories	Options Available
Installation Kits	Soldering Kit, Heashrink Kit, Silicone Tube

### **(\*) NOTES**

- The Power Rating has been measured with the strip power in both ends
- A good technique to minimize voltage drop and increase lumens output is to power the strip on both ends.
- LED electrical and optical characteristics change with the die manufacturing date.
- LED performance and life span is affected by environmental conditions, manufacturing techniques and actual components characteristics.
- We reserve the right to change any data without prior notice.

## Segment Close Up and Dimensions

Top View

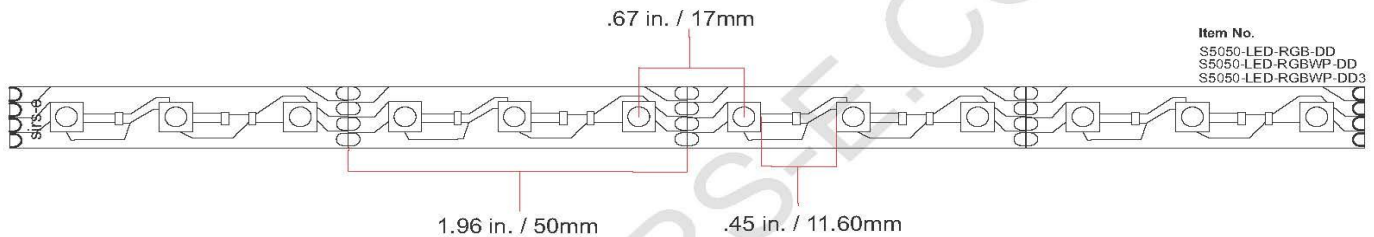

Front View

